

नींव आपके सपनों की....

nirvana

L I F E S P A C E

4 BHK Ultra Luxury Apartments



ABOUT NIRVANA LIFESPACE

The historical city of Kanpur is on the brink of renewed resurgence with sustained real estate, industrial and trading growth over the past few years. Life style patterns have changed and "comfort living" is the new buzz on the horizon. With the city limits stretching towards North prime real estate development is expanding on the road to vikas nagar - The Life line of Kanpur.

Design, Comfort, Style and Space. All in one vicinity coming together in a symphony at Nirvana Lifespace - your own place A place you can call "Home". A place where you cherish what you desire. A place which gives you a sense of higher the abode of "GOD"

Welcome to the very epitome of fine Architecture at Nirvana Lifespace a cluster of Luxury 4BHK Apartment, with a gracefully and creatively designed, in a private, peaceful and serene environment. Situated near Manorama Palace Guest House. Nirvana Lifespace is a beautiful amalgamation of luxury and comfort which are delightful to the mind, body and soul.





Structure- Earthquake resistant
RCC structure

(Govt. Institution Approved)

Roof terrace- marble finish terrace

External fittings- water proof paint as per elevation

Driveway- inter locking pavers/
checked tiles/RCC

Common power backup- 24x7 hrs.
100% power backup for lift & common
area facility by solar power
and genset

Electrical – concealed conduit with copper wires. Modular switches & socket. All circuits protected by MCB. Power points for AC in drawing / dining, bedrooms & sockets for TV & telephone outlet in drawing/ dining, bedroom.

Lifts– high speed elevators

Utility & facility- piped gas supply

Security- 24 hours main gate security

Fire protection- fire protection as per latest norms

Water supply- water supply through water head tank connected through water softener plant

Master bedroom/bedroom/drawing & dining-

Flooring: vitrified Tiles

Walls: Wall Putty & Paint

Internal/external doors: Wooden door frame with decorated
flush doors with branded fittings

Windows: wooden frame
with teak wood shutter
with MS grill
& branded fittings



- **Kitchen- flooring:** Vitrified Tiles,
- **Walls:** Designer Glazed tiles upto 2fts.
- **Counter top, Ceiling:** Birla Putty
- **Toilets- Flooring:** Designer non skid
tiles **Walls:** Designer glazed tiles
upto 7fts.
- **Internal/external doors:** wooden
door frame with flush door with
branded fittings
- **Windows:** wooden frame with teak
wood shutter with MS grill & branded
fittings
- **Others:** Designer granite counter with
wash basin, premium quality EWC
and branded elegant CP fitting





Premium Residential Apartment 4BHK - Flat-A (1620 Sq.ft.), Flat-B (1620 Sq.ft.) @ Vikas Nagar

While it is common to come across developers who offer small cramped flats which do not end up serving adequate space requirement, our innovation in building apartment came in as much needed freshness in the residential space.

With a total area about 14418 sq.ft, we feel humble to have already received encouraging response from the time we have opened booking, and feel proud with our contribution in helping loving families like yours to find their sweet abode.

TYPICAL FLOOR PLAN

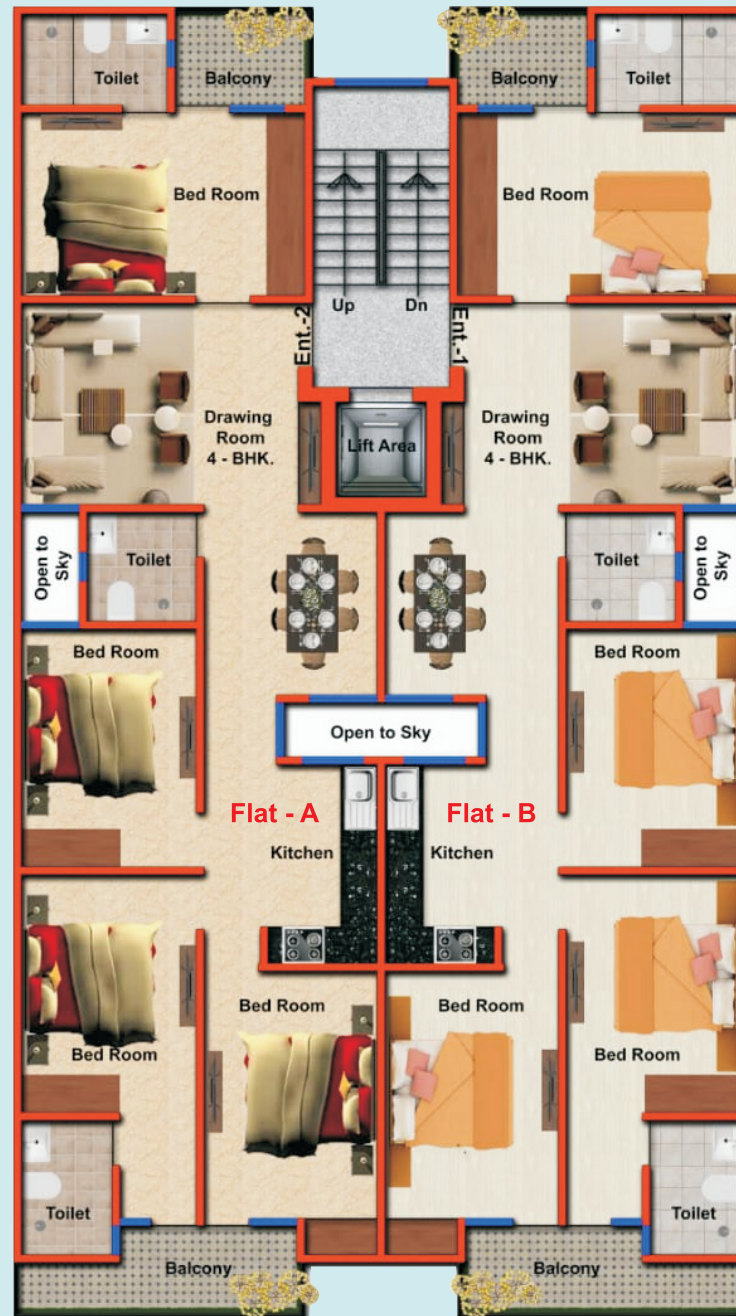

Luxurious Detailing :

We constantly make an effort to inculcate global best practices in our project and services while including latest technological advancement & innovation which may benefit to our customer.

- Installing of LED light for reduced power consumption
- Rain water harvesting plant
- Procurement & usage of branded raw material and fixtures ensuring durability and efficiency
- Provision of adequate internet and Wi-Fi services
Tie-ups with leading financial institutions for purchase assistance
- Anti terminate treatment
- Decorative entrance lobby
- Enabling a team of qualified & expert professionals which help a customer through the entire purchase process of an offering
- First of its kind after sales support
- Before time possession
- CCTV integrated with cable TV
- Centralized intercom facility
- Ready cable connection
- Concealed copper wiring with circuit breakers



THE BRANDS WE ARE PROUDLY ASSOCIATED WITH

Paint & Putty



Wire & Cable



Cement



Faucets & Fit



Tiles



Switches



Sink



Pipes



Tanks



Steel



Solar Panel



C.C.TV And Video Door Phone



AAC Block



Doors By



Fire Service



Waterproof Plaster And Block Jointer



* THE PRODUCTS MAY VARY DEPENDS ON AVAILABILITY

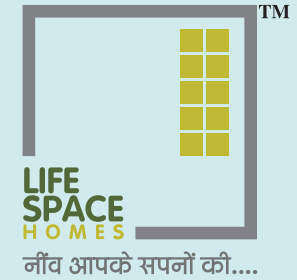

Office Address :

Office No. 5, 6, 7, 8 Galleria Market, Vikas Nagar, Kanpur- 208 024

For Booking Please Contact :

+91-9519307201, +91-9519307210, +91-9519307200

For Online Booking Please Contact

Web : www.chaudharylifespace.com | E-mail : care@chaudharylifespace.com

[facebook.com/ChaudharyLifeSpace](https://www.facebook.com/ChaudharyLifeSpace) [linkedin.com/company/ChaudharyLifeSpace](https://www.linkedin.com/company/ChaudharyLifeSpace)

*All the information is strictly for guidance purpose only and does not constitute part of an offer or contract.

*All visuals/ photographs used in this brochure are artists impression.

*All specifications, sizes and layouts are tentative and subject to such variation, additions and modifications as decided by the Architects or by the Promoters.